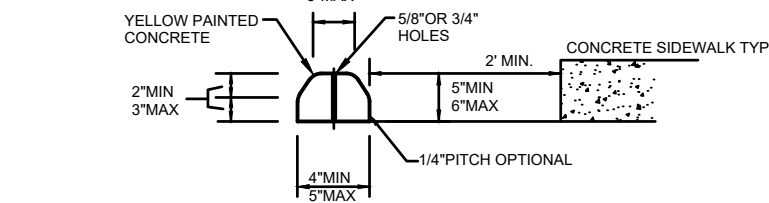
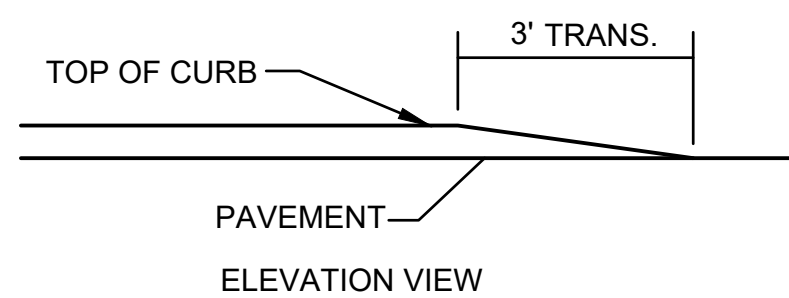
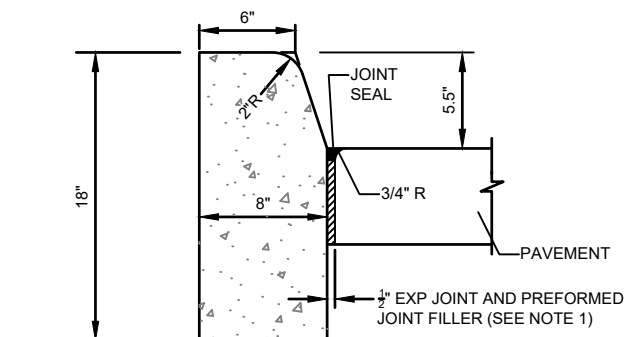
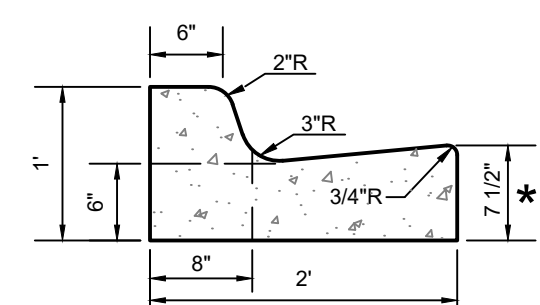
**STANDARD SIGN BASE****CONCRETE WHEEL STOP**
N.T.S.**GENERAL NOTES**

- FOR USE ADJACENT TO CONCRETE OR FLEXIBLE PAVEMENT. EXPANSION JOINT, PREFORMED JOINT FILLER AND JOINT SEAL ARE REQUIRED BETWEEN CURBS AND CONCRETE PAVEMENT ONLY.
- THE CONCRETE FOR CURBS SHALL BE DEPARTMENT OF TRANSPORTATION CLASS "I" CONCRETE, AND HAVE A COMPRESSIVE STRENGTH OF 3000 PSI.
- ALL CURBS SHALL HAVE CONTRACTION JOINTS AND SHALL BE CONSTRUCTED AT INTERVALS NOT TO EXCEED 10'-0" ON CENTERS FOR ALL CURBS.

TYPE "D" CURB DETAIL
N.T.S.

★ WHEN USED ON HIGH SIDE OF ROADWAYS, THE CROSS SLOPE OF THE GUTTER SHALL MATCH THE CROSS SLOPE OF THE ADJACENT PAVEMENT. THE THICKNESS OF THE LIP SHALL BE 6", UNLESS OTHERWISE SHOWN ON PLANS.

GENERAL NOTES:

- THE CONCRETE FOR CURBS SHALL BE DEPARTMENT OF TRANSPORTATION CLASS "I" CONCRETE, AND HAVE A COMPRESSIVE STRENGTH OF 3,000 PSI.
- ALL CURBS SHALL HAVE CONTRACTION JOINTS AND SHALL BE CONSTRUCTED AT INTERVALS NOT TO EXCEED 10'-0" ON CENTERS FOR ALL CURBS.

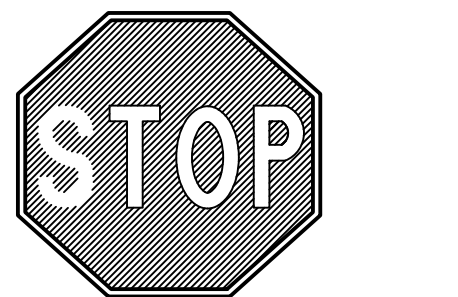
STANDARD CONCRETE CURB & GUTTER
N.T.S.

30" x 30" OR
24" x 24" (FOR ON SITE ONLY)
HIGH INTENSITY
R1-1

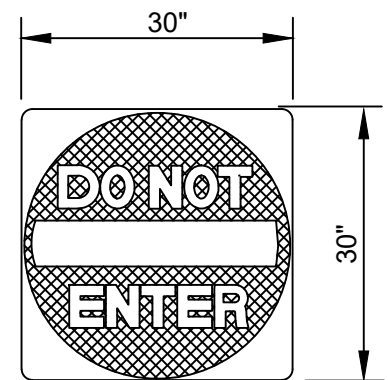
STOP SIGN

STANDARD RED AND WHITE SIGN
R5-1

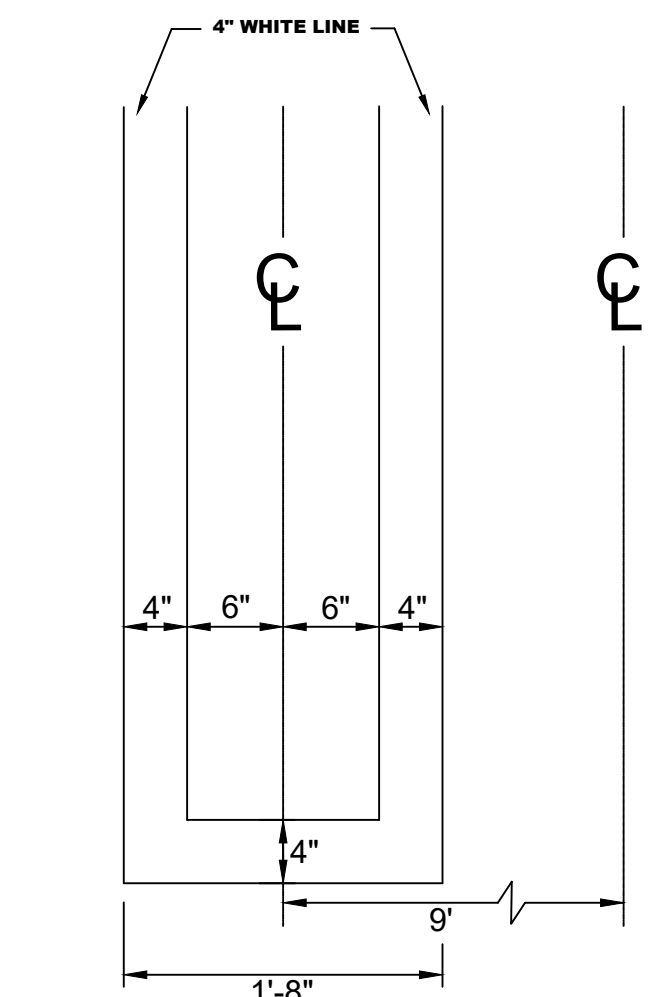
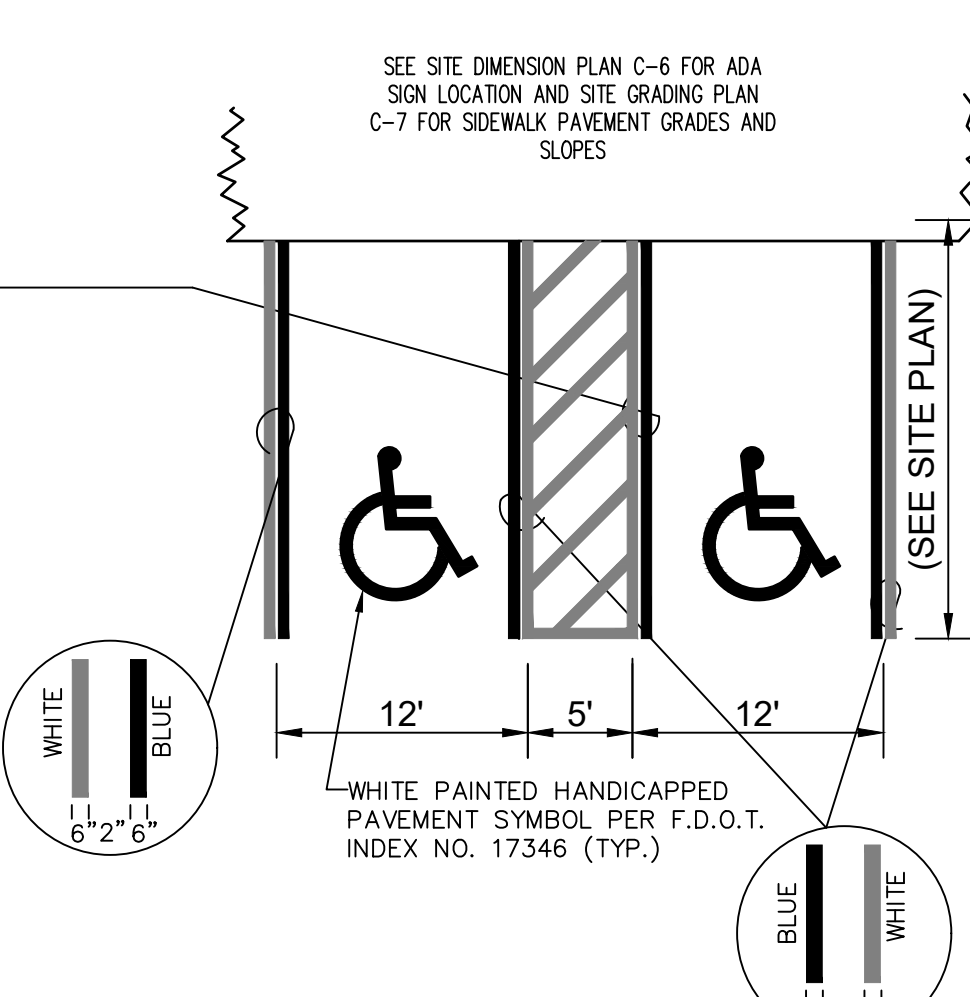
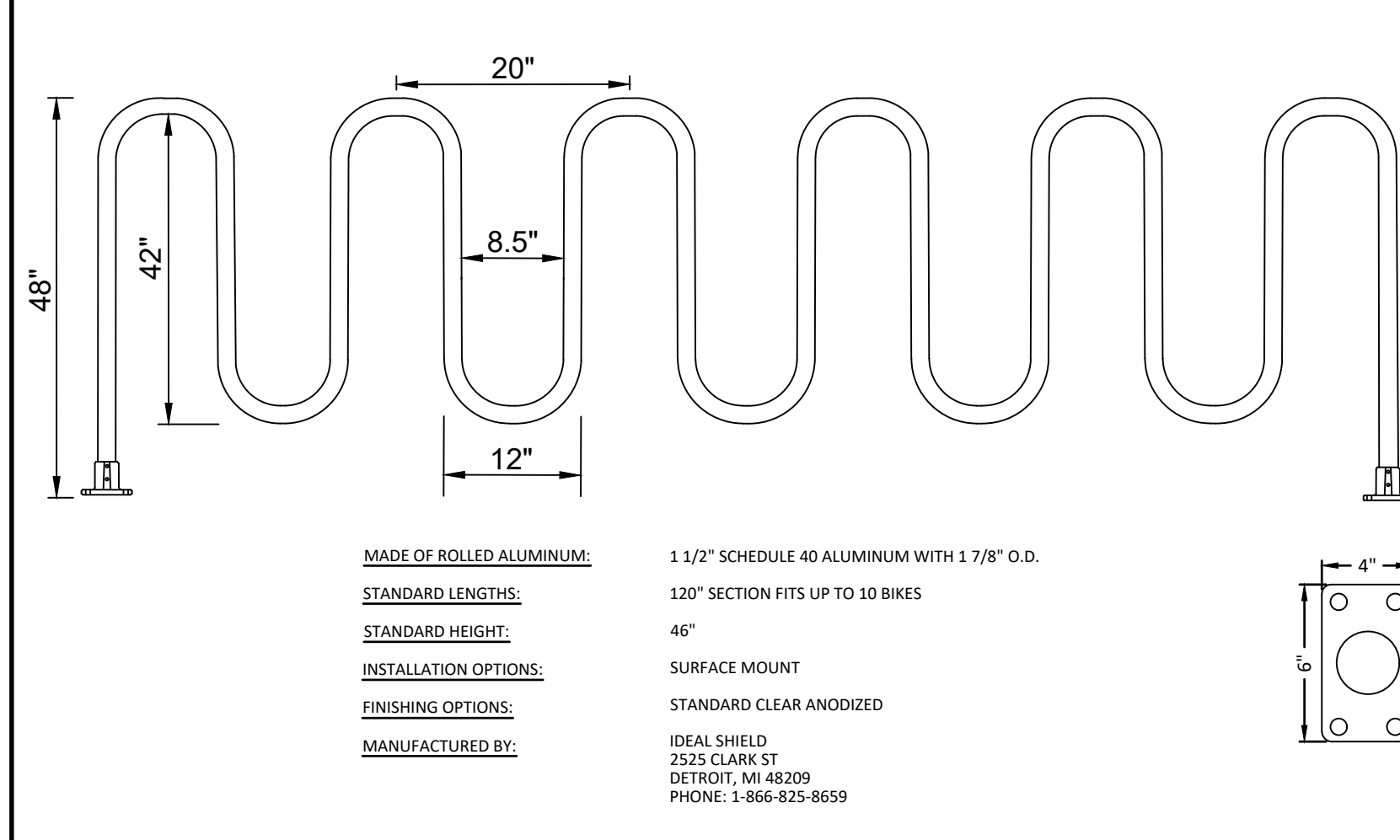
"DO NOT ENTER" SIGN**PARKING STRIPE DETAIL**
N.T.S.**HANDICAP STRIPING DETAIL**
N.T.S.**STANDARD (10) BICYCLE RACK DETAIL**
N.T.S.**B.C.H.C.E.D. REF. NO. 200617002****NOTE:**

ALL SIGNS AND PAVEMENT MARKINGS SHALL BE IN ACCORDANCE WITH THE "MANUAL ON UNIFORM TRAFFIC CONTROL DEVICES" AND THE LATEST IMPLEMENTED EDITION OF FDOT ROADWAY AND TRAFFIC DESIGN STANDARDS AND BROWARD COUNTY TRAFFIC ENGINEERING DIVISION CURRENT STANDARDS.

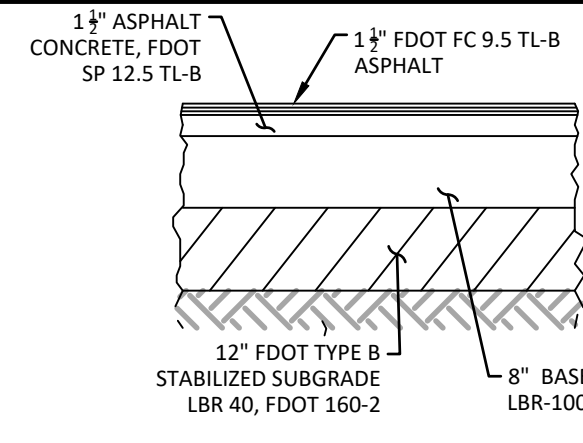

NOTE: TO BE CONSTRUCTED PER FDOT SPECIFICATIONS (INDEX 330-001)

**STANDARD DUTY ASPHALT
PAVEMENT TYPICAL CROSS SECTION**
N.T.S.

- BASE:
- FDOT SHELL ROCK, BANK RUN SHELL, LIMEROCK, CRUSHED CONCRETE OR CEMENT COQUINA BASE. LBR-100
 - BASE TO MEET LOCAL, FDOT, GEOTECHNICAL REPORT & FDOT SPECIFICATIONS



DESIGN

666 N.E. 125th STREET,
SUITE 247
NORTH MIAMI, FL 33161
Phone: 305.720.2079
C.O.A. 33221

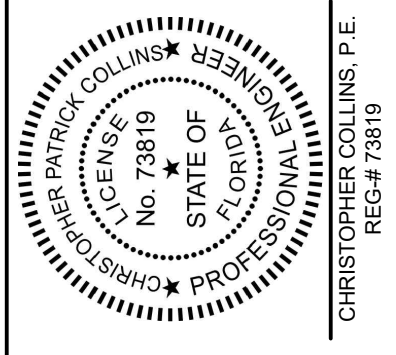

3/11/2024

This item has been digitally signed and sealed by Christopher P. Collins, P.E. on the date adjacent to the seal.

Printed copies of this document are not considered signed and sealed and the signature must be verified on any electronics copies.

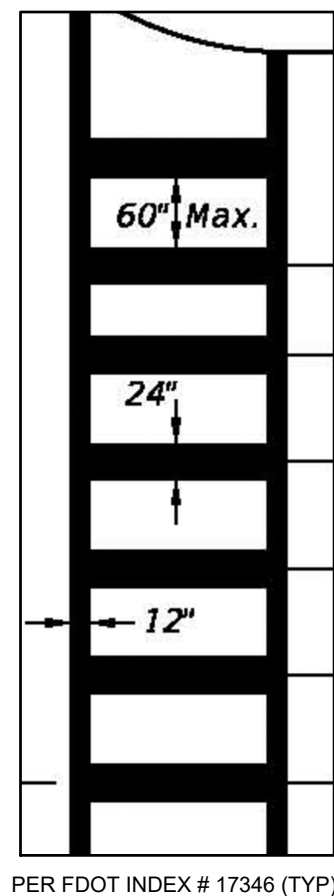
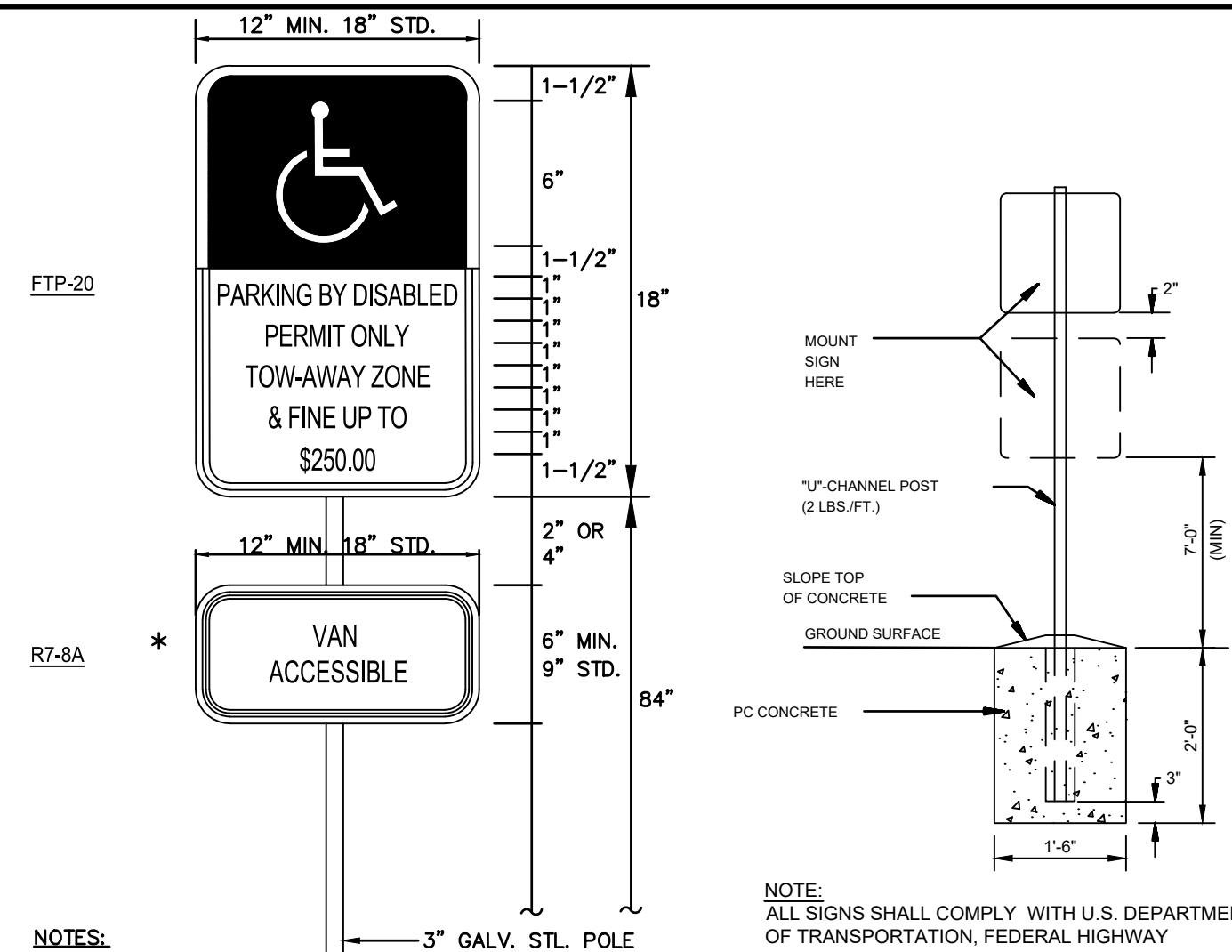
**CROSSWALK DETAIL**
N.T.S.**NOTES:**

SIGNS FTP-25 AND R7-8A SHALL BE IN ACCORDANCE WITH F.D.O.T. INDEX NO. 17355 AND SHALL MEET THE REQUIREMENTS OF FLORIDA STATUTES 316.1955 AND 316.1956.

★ SIGNS "\$250.00 FINE" AND "R7-8A" PER LOCAL REQUIREMENTS.

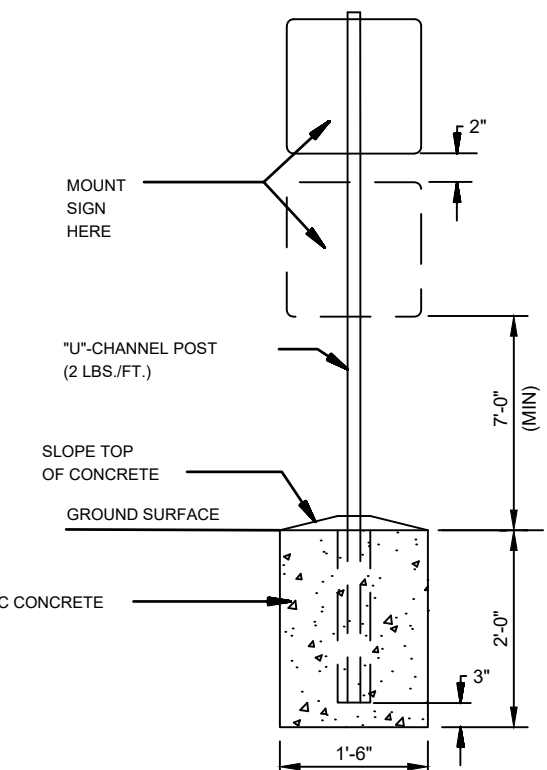
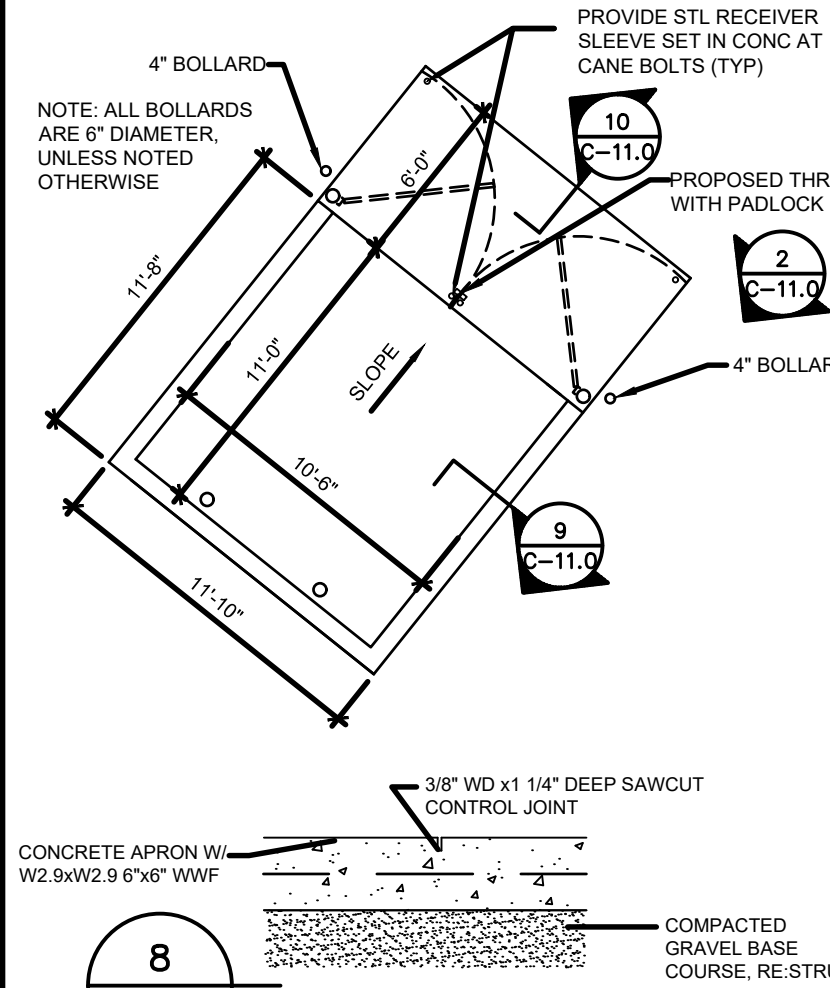
HANDICAP SIGN DETAIL
N.T.S.**STANDARD SIGN BASE**
N.T.S.**8**
C-11.0

SCALE: NTS

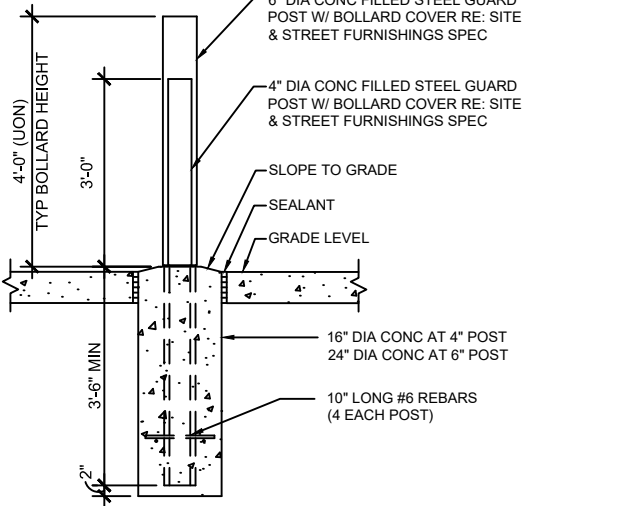
**6**
C-11.0

SCALE: NTS

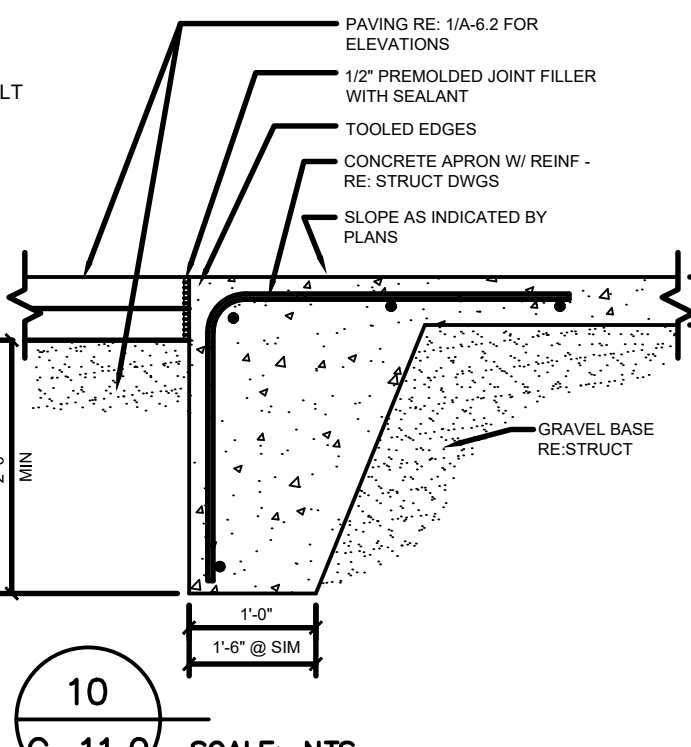
**10**
C-11.0

SCALE: NTS

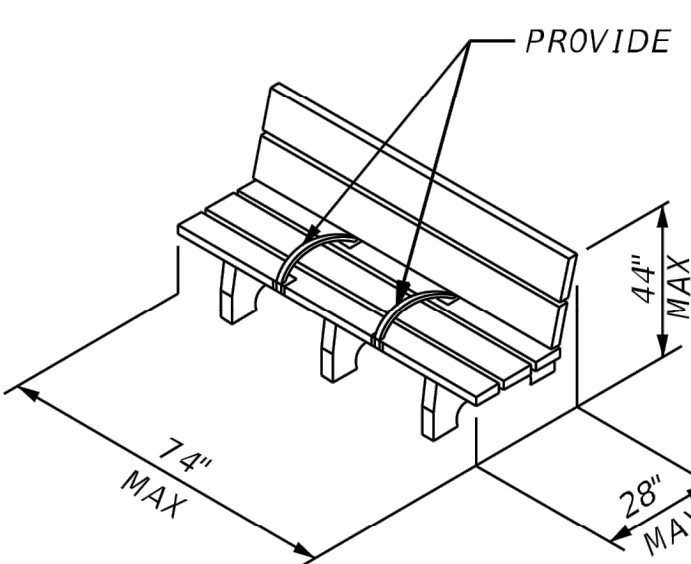
**BENCH DETAIL**
N.T.S.**PERMIT SET**
MUST BE ON JOBSITE AT ALL TIMES DURING CONSTRUCTION**NOTICE**
INSPECTION REQUIRED

24 HRS. PRIOR TO COMMENCING ANY WORK IN THE PUBLIC ROW CONTACT THE BROWARD COUNTY HIGHWAY CONSTRUCTION AND ENGINEERING DIVISION AT 954-577-4600 FOR INSPECTION.

NOTE: APPROVAL OF THIS PLAN DOES NOT CONSTITUTE A PERMIT FOR CONSTRUCTION.

A PERMIT FOR CONSTRUCTION MUST BE OBTAINED FROM THE BROWARD COUNTY HIGHWAY CONSTRUCTION AND ENGINEERING DIVISION PRIOR TO COMMENCING CONSTRUCTION IN THE PUBLIC RIGHT OF WAY.

ALL MATERIALS USED AND INSTALLATIONS WITHIN THE PUBLIC RIGHT OF WAY OR EASEMENTS SHALL BE IN ACCORDANCE WITH BROWARD COUNTY HIGHWAY CONSTRUCTION AND ENGINEERING DIVISION SPECIFICATIONS.

BROWARD COUNTY HIGHWAY CONSTRUCTION AND ENGINEERING DIVISION

☐ PLAN CONSISTENT WITH PLAT REQUIREMENTS

☐ PUBLIC RIGHT OF WAY APPROVAL FOR PAVING, GRADING AND DRAINAGE

BY: _____ DATE: _____

DOES NOT INCLUDE APPROVAL OF PAVEMENT MARKINGS & SIGNS

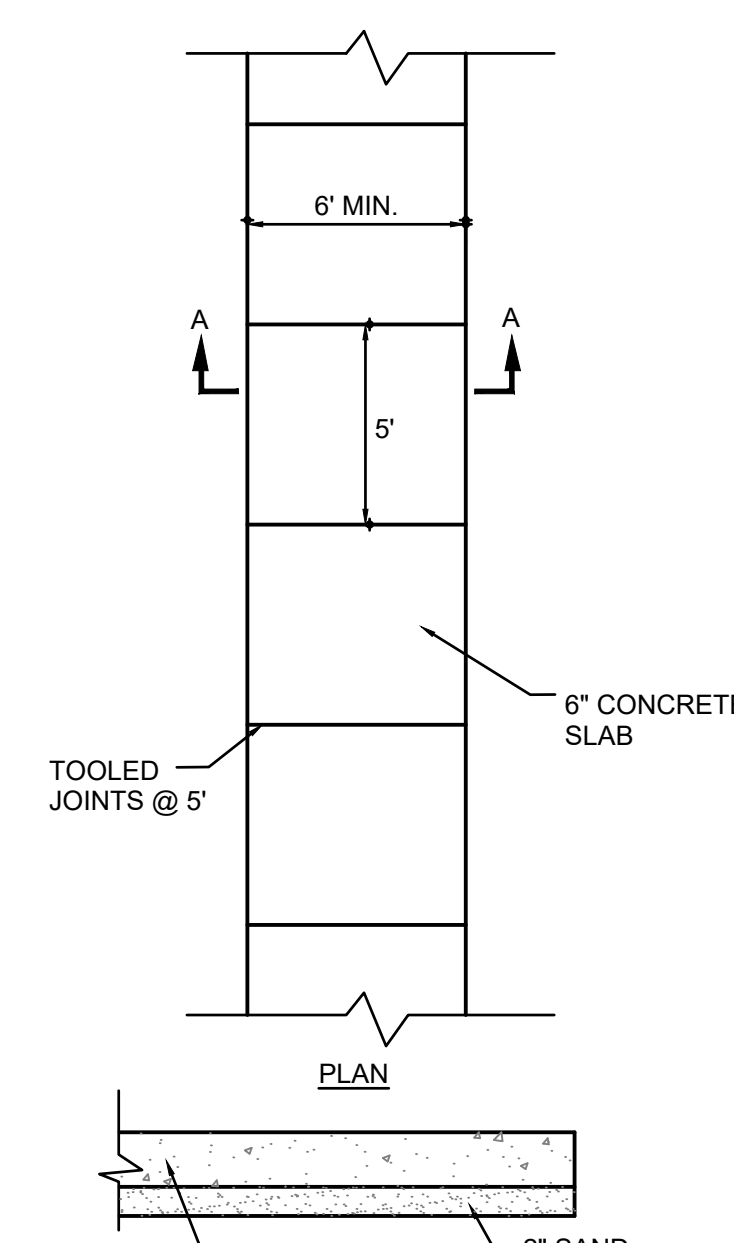

TOOLED JOINTS @ 5'

6" CONCRETE SLAB

4" P.C. CONCRETE

MINIMUM 3000 P.S.I. CONCRETE REQUIRED

NOTES:

- 3/4"x4" PREMOULDED EXPANSION MATERIALS AROUND P.P. OR OTHER STRUCTURES IN WALK.
- EXPANSION JOINTS MAXIMUM DISTANCE = 100', USED 3/4"x4" PREMOULDED EXPANSION MATERIAL.
- CONTRACTION JOINTS MAXIMUM DISTANCE = 21', SAW CUT 2" DEEP AND FILL WITH HOT POURED SEALER.
- SAW CUT JOINTS WITHIN 24 HOURS.

CONCRETE SIDEWALK DETAIL
N.T.S.**Sunshine**

Call 811 or visit sunshine811.com two full business days before digging to have buried facilities located and marked.
Check positive response codes before you dig!

Revision Date
Comment

Revision Date
Comment

Revision Date
Comment

Revision Date
Comment

Revision Date
Comment

Revision Date
Comment

Revision Date
Comment

Revision Date
Comment

Revision Date
Comment

Designed by: C.P.C.

Drawn by: A.T.S.

Checked by: C.P.C.

Approved by: C.P.C.

Scale: N.T.S.

Date: 05/25/2022

Job No.: 1002

© 2025

Plans for
FESTIVAL MARKETPLACE
2900 W SAMPLE ROAD
POMPAHO BEACH,
FLORIDA

GENERAL DETAILS

Sheet No.

C-11.0